



# Installation Instructions

**Model: MV-1400MA8**



## **FEATURES:**

- High Resolution, 1/4" CMOS Color Camera
- Compact Metal Die Cast Body
- Waterproof Housing
- Wide Angle Lens: Diagonal 140 Degree
- Selectable Normal or Reverse Image

## Camera View:

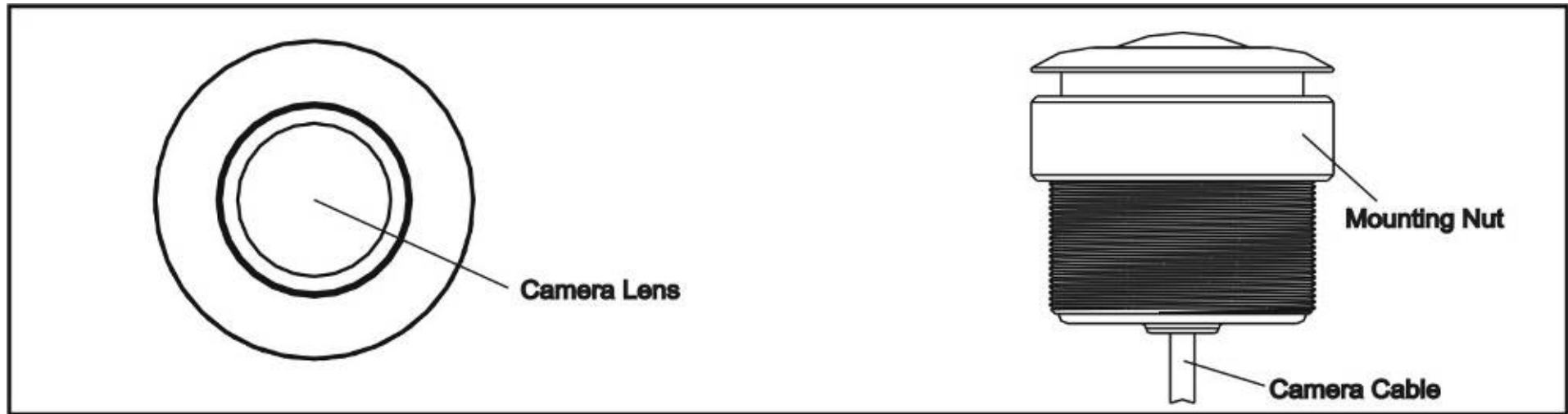

## Cable Connector End View:

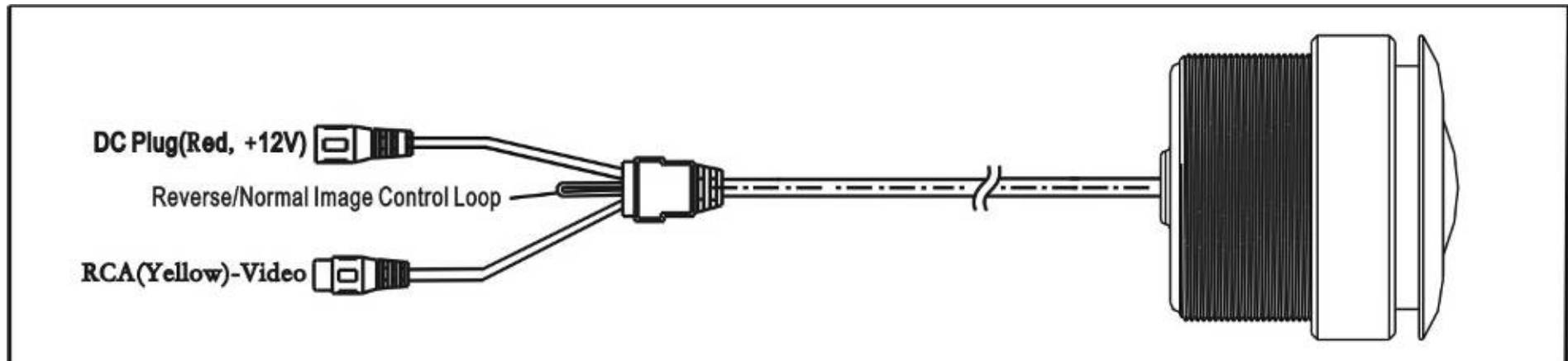

## **Specification:**

1. Voltage: DC12V
2. Operation Current: 50mA
3. Signal System: NTSC
4. Image sensor: 1/4" CMOS Sensor
5. Horizontal Resolution: 420 TV Lines
6. Viewing Angle: 140 degrees
7. Minimum Illumination: 0.3 Lux
8. Image Display: Normal Image or Reverse Image
9. Camera Outer Dimensions: 22 ( $\Phi$ ) X23 (H) mm

## Camera Installation:

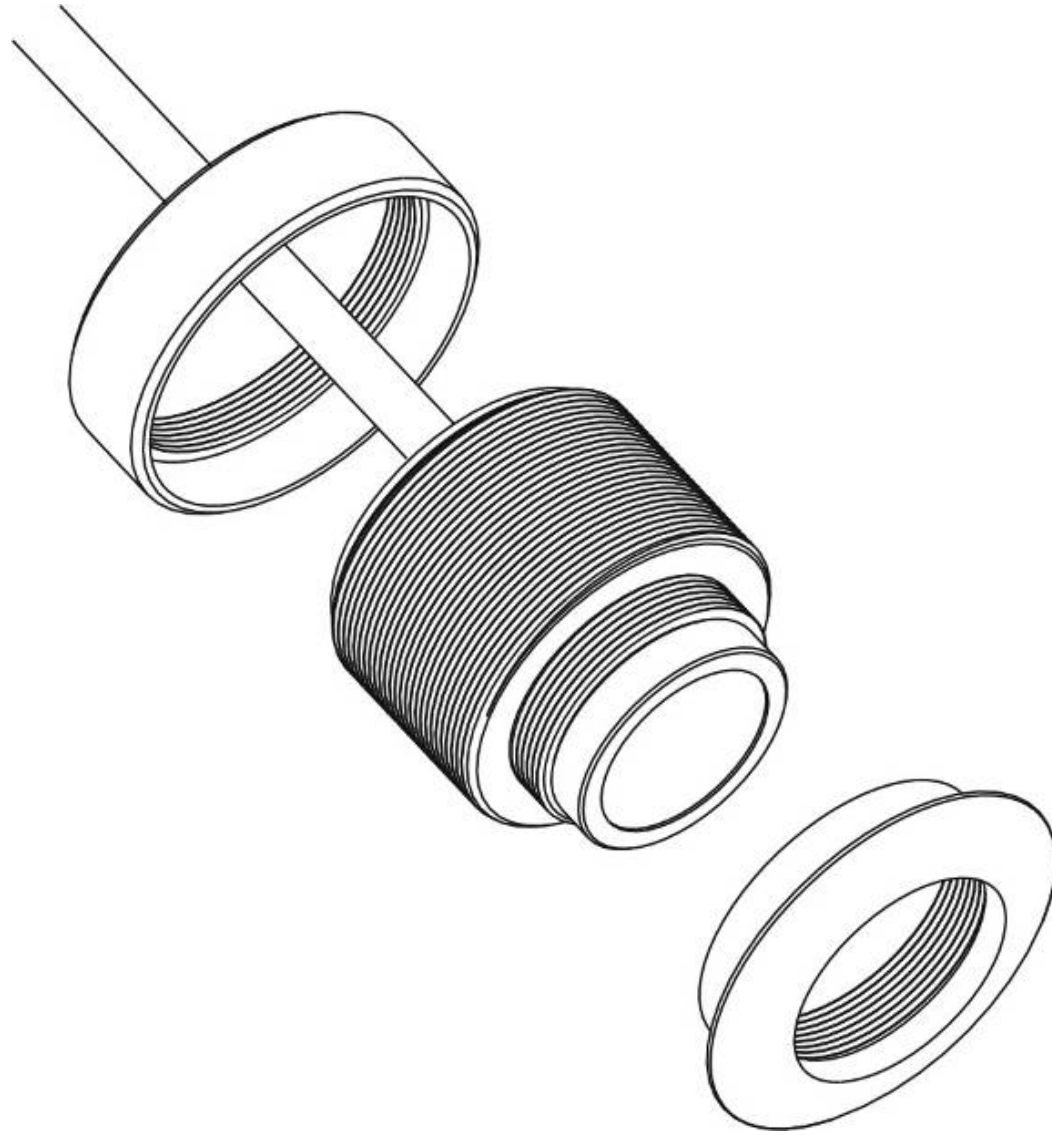

## **Camera Installation:**

- 1、 Select a suitable mounting location on or up of vehicle license plate.
- 2、 Use a special aiguilles drill a  $\Phi 21.5\text{mm}$  holes as the camera's installation hole, Caution before drilling check behind area to be drilled to insure no wires or mechanisms interfere or could be damaged during drilling. Check for interference with license plate lights, hatch release switch and/or mechanism.
- 3、 Route the camera cable connector through into the drilled hole, then let the camera insert to the hole until the mounting bracket to the mounting location. Coat edge of hole with rust preventative.
- 4、 Wiring the Camera cable to the vehicle reverse lamp.

- a) Locate the reverse lamp in the tail light;

The red DC plug of the camera connected to the DC plug of supplied and the DC plug other side (red and black wires) connected to the reverse lamp.

- b) Yellow RCA-connect to Video input

- c) Reverse/Normal Image loop: The blue loop is located at the camera cable connector with blue loop installed in the harness; the camera image is pre-wired for normal image. If mounting camera on the front of the vehicle cut the blue wire loop to change the camera image to reverse, tape the cut wires with electrical tape.



[www.mediaviewtech.com](http://www.mediaviewtech.com)

---

© MediaView Technologies Corporation